

## 34 Senior Lane , Salford, M3 7FE

This superb four bedroom townhouse is spread over three floors and forms part of the second phase of Urban Splash's award winning new concept homes at Irwell Riverside, a new and inviting neighbourhood perfectly positioned on the edge of the River Irwell and a short walk from Manchester city centre. The modern property offers over 1500 square foot of bright and spacious interior with solid wood flooring throughout, large windows, and high ceilings. On the ground floor there is a large open plan living room with access to the private rear garden via two sets of patio doors, central kitchen diner area with integrated appliances and a WC. On the first floor there are two double bedrooms (one with access to a balcony) and a family bathroom suite. At the top of the house there are two further generously sized double bedrooms both with en suite shower rooms and two storage cupboards housing a washing machine and ventilation system. The house also benefits from a driveway providing off road parking.

**Offers Over £400,000**

# 34 Senior Lane

, Salford, M3 7FE



- Three Floors of Spacious Accommodation
- Walking Distance to Manchester City Centre
- Downstairs WC
- Popular Residential Area Close to River Irwell
- Four Double Bedrooms
- Driveway Providing Off Road Parking
- Private Garden with Decking
- Urban Splash Designed House
- Two En Suite Shower Rooms & Family Bathroom
- Modern Townhouse Property



[Directions](#)





# Floor Plan

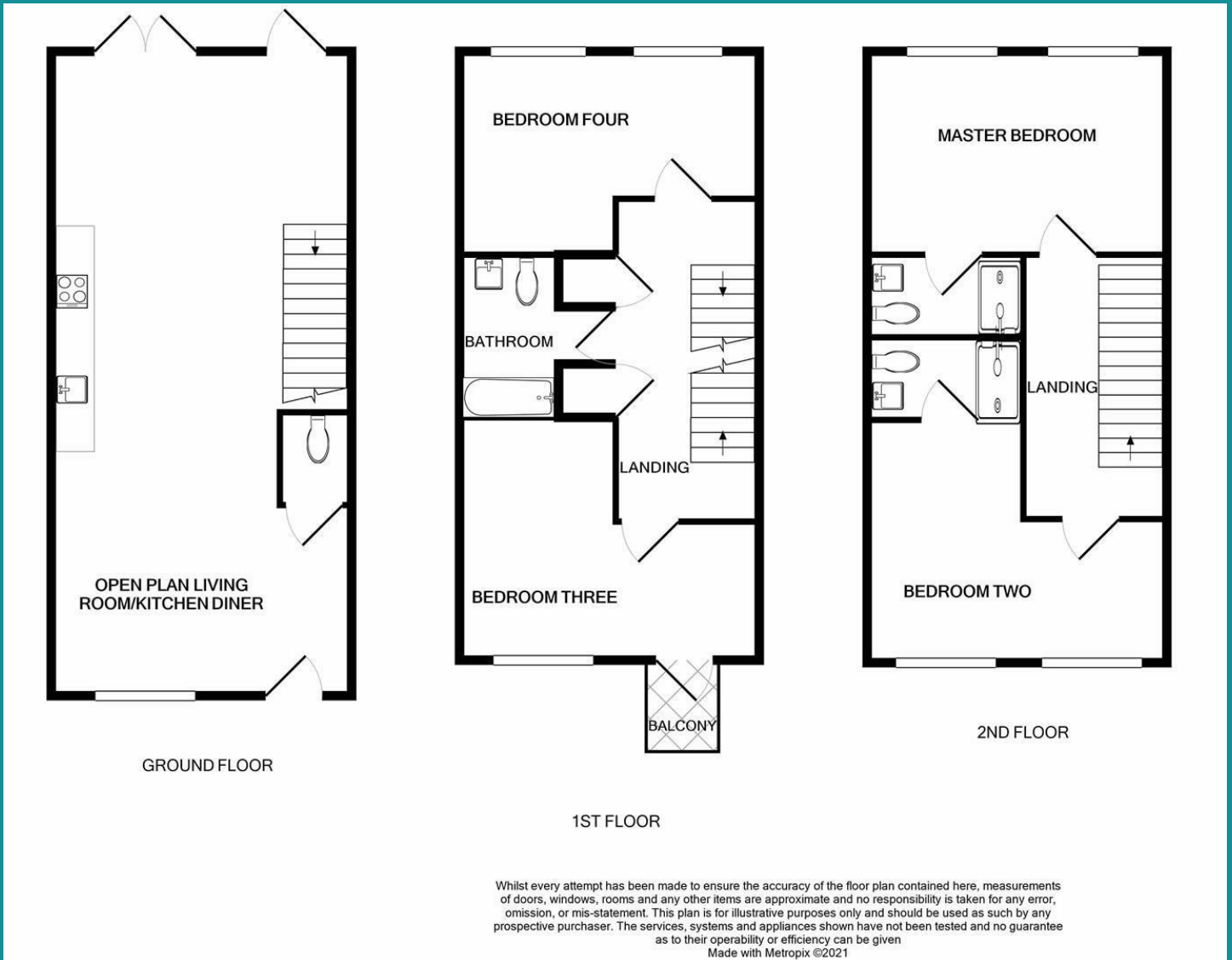

These particulars, whilst believed to be accurate are set out as a general outline only for guidance and do not constitute any part of an offer or contract. Intending purchasers should not rely on them as statements of representation of fact, but must satisfy themselves by inspection or otherwise as to their accuracy. No person in this firm's employment has the authority to make or give any representation or warranty in respect of the property.

